

01767548
COLLIER COUNTY

93 DEC -9 PM 1:39
RECORDED

001892
OR BOOK

001828
PAGE

REC 17.00
PRM 2.50
DOC _____
INT _____
IND _____

**CERTIFICATE OF AMENDMENT
TO THE DECLARATION OF CONDOMINIUM
FOR
BERMUDA GREENS, A CONDOMINIUM**

This Amendment, made this 19TH day of November, 1993, by BERMUDA GREENS OF NAPLES, LTD., a Florida limited partnership (the "Developer").

WHEREAS the Developer has recorded a Declaration of Condominium for BERMUDA GREENS, A CONDOMINIUM, in Official Records Book 1662, Pages 1248 through 1352, inclusive, as amended, of the Public Records of Collier County, Florida; and

WHEREAS Section 22 of said Declaration reserves the right of the Developer to make amendments to the Declaration of Condominium to comply with Section 718.104(4)(e), Florida Statutes; and

WHEREAS the Developer wishes to amend said Declaration for the purpose of certifying substantial completion of Building S as required by Section 718.104(4)(e), Florida Statutes.

NOW, THEREFORE, the Developer hereby amends the aforesaid Declaration by adding new pages 43 and 44 to Exhibit "B", to reflect substantial completion of Building S.

IN WITNESS WHEREOF, the Developer has caused this Certificate to be duly executed this 9 day of November, 1993.

SIGNED, SEALED AND DELIVERED
IN THE PRESENCE OF:

BERMUDA GREENS OF NAPLES, LTD.
a Florida limited partnership

Adrianne M. Gordon
Witness: Adrianne M. Gordon

BY: CBG OF NAPLES, INC.
GENERAL PARTNER

Kathleen Anne White
Witness: Kathleen Anne White

BY: Stuart M. Wallace
Stuart M. Wallace, President
800 Seagate Drive, Suite 301
Naples, Florida 33940

(CORPORATE SEAL)

Return to:
Forsyth, Briggs, DeMa
& Bourgeois, P.A.
600 5th Ave. South, Suite 210
Naples, Florida 33910
ATTN: Kelly White

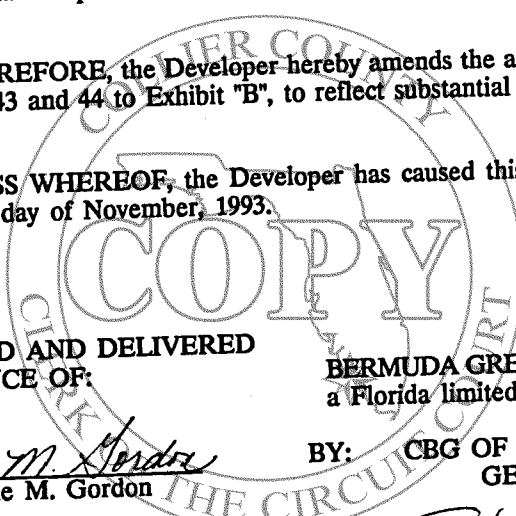

001892
OR BOOK

001829
PAGE

STATE OF FLORIDA
COUNTY OF COLLIER

The foregoing instrument was acknowledged before me this 19 day of November, 1993, by **STUART M. WALLACE**, President, of **CBG OF NAPLES, INC.**, a Florida corporation, the general partner of **BERMUDA GREENS OF NAPLES, LTD.**, a Florida limited partnership, on behalf of the partnership. He is personally known to me.

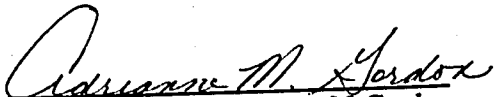
NOTARY PUBLIC: Adrienne M. Gordon

My commission expires:



This instrument prepared by:
Carol R. Brugger, Esquire
FORSYTH, BRUGGER, REINA & BOURGEOU, P.A.
600 Fifth Avenue South, Suite 210
Naples, Florida 33940
(813) 263-6000

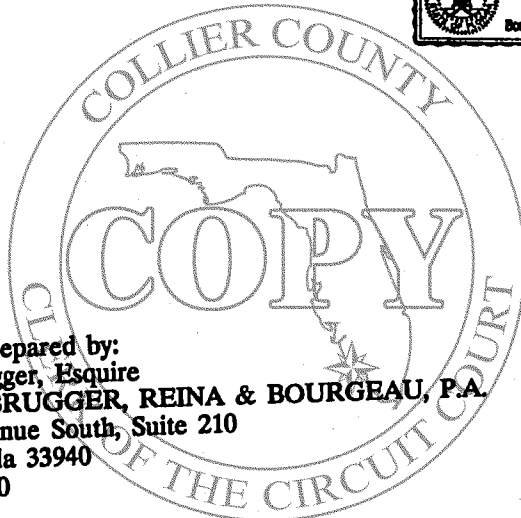

001892
OR BOOK

001830
PAGE



SURVEYORS CERTIFICATE OF SUBSTANTIAL COMPLETION

CERTIFICATE OF SURVEYOR made this 19th day of November 1993.

This certificate is made as to Building "S" of Bermuda Greens, A Condominium, Phase 3, located at Naples, Collier County, Florida, pursuant to Section 718.104 (4) (e), Florida Statutes.

I, Carol E. Nelson, a Land Surveyor authorized to practice in the State of Florida, hereby certify that the construction of the above referenced building, and all planned improvements, including but not limited to the landscaping, utility services, access to the units and common element facilities serving the building, have been substantially completed, so that the material attached to the Declaration of Condominium as Exhibit "B" together with the provisions of the Declaration describing the condominium property, is an accurate representation of the location and dimensions of the improvement, and that the identification, location and dimensions of the common elements and of each unit can be determined from these materials.

Prepared by:

Carol E. Nelson 11/19/93
Carol E. Nelson, P.L.S.
Florida Registration No. 5013

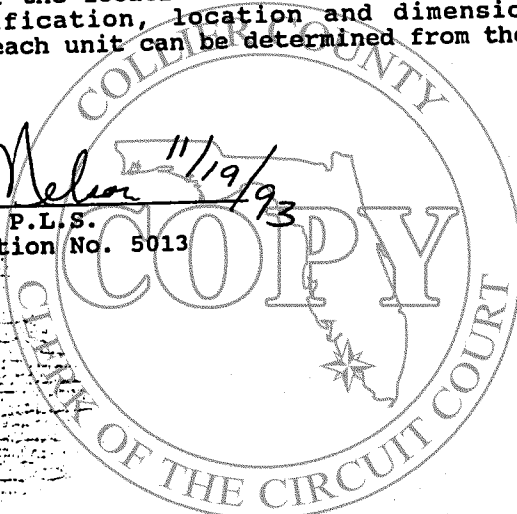

EXHIBIT "B",

Page 43

5101 Tamiami Trail East, Suite 202 Naples, Florida 33962
(813) 775-0723 Fax (813) 775-9236

001892
OR BOOK

001831
PAGE

CONDOMINIUM PLAT BOOK _____ PAGE _____

BERMUDA GREENS, A CONDOMINIUM

PHASE III

PHASE 4

PHASE 3

PHASE 2

PHASE 1

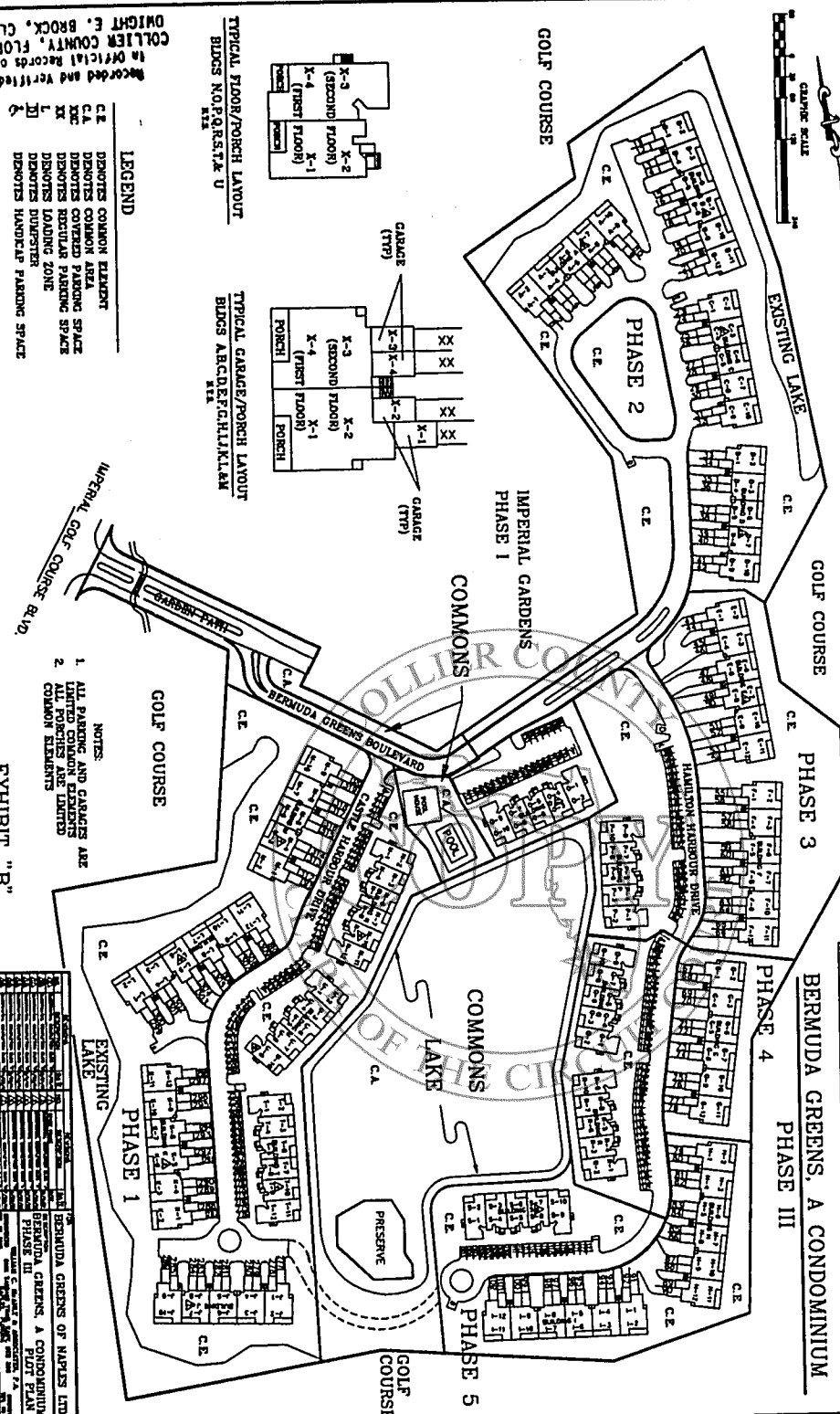

Recorded and Verified
in Official Records of
COLLIER COUNTY, FLORIDA
DWIGHT E. BROCK, CLERK

- LEGEND**
- CE DENOTES COMMON ELEMENT
 - CA DENOTES COMMON PARKING SPACE
 - XX DENOTES REGULAR PARKING SPACE
 - XX DENOTES LOADING ZONE
 - H DENOTES HANDICAP PARKING SPACE

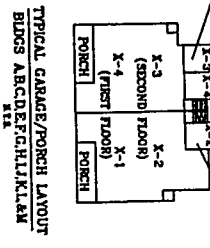
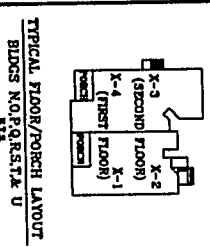

- NOTES:**
- 1 ALL PARKING AND GARAGES ARE LIMITED COMMON ELEMENTS
 - 2 ALL FLOOR ELEMENTS COMMON ELEMENTS

PHASE	UNIT NO.	AREA	TYPE	REMARKS
PHASE III	101	101	CE	
	102	102	CE	
	103	103	CE	
	104	104	CE	
PHASE IV	201	201	CE	
	202	202	CE	
	203	203	CE	
	204	204	CE	
PHASE V	301	301	CE	
	302	302	CE	
	303	303	CE	
	304	304	CE	
PHASE VI	401	401	CE	
	402	402	CE	
	403	403	CE	
	404	404	CE	
PHASE VII	501	501	CE	
	502	502	CE	
	503	503	CE	
	504	504	CE	

when received.