

**CERTIFICATE OF AMENDMENT
TO THE DECLARATION OF CONDOMINIUM
FOR
BERMUDA GREENS, A CONDOMINIUM**

This Amendment, made this 12th day of April, 1993, by BERMUDA GREENS OF NAPLES, LTD., a Florida limited partnership (the "Developer").

WHEREAS the Developer has recorded a Declaration of Condominium for BERNUDA GREENS, A CONDOMINIUM, in Official Records Book 1662, Pages 1248 through 1352, inclusive, as amended, of the Public Records of Collier County, Florida; and

WHEREAS Section 22 of said Declaration reserves the right of the Developer to make amendments to the Declaration of Condominium to comply with Section 718.104(4)(e), Florida Statutes; and

WHEREAS the Developer wishes to amend said Declaration for the purpose of certifying substantial completion of Building O as required by Section 718.104(4)(e), Florida Statutes.

NOW, THEREFORE, the Developer hereby amends the aforesaid Declaration by adding new pages 39, and 40 to Exhibit "B", to reflect substantial completion of Building O.

IN WITNESS WHEREOF, the Developer has caused this Certificate to be duly executed this 12th day of April, 1993.

SIGNED, SEALED AND DELIVERED
IN THE PRESENCE OF:

Adrienne M. Gordon
Witness: Adrienne M. Gordon

Kathleen Anne White
Witness: Kathleen Anne White

BERMUDA GREENS OF NAPLES, LTD.
a Florida limited partnership

BY: *Stuart M. Wallace*
GENERAL PARTNER

BY: *Stuart M. Wallace*
Stuart M. Wallace, President
800 Seagate Drive, Suite 310
Naples, Florida 33940

(CORPORATE SEAL)

OR BOOK
1818

PAGE
001786

↑ FORSYTH, BRUGGER, ET AL ATTORNEYS

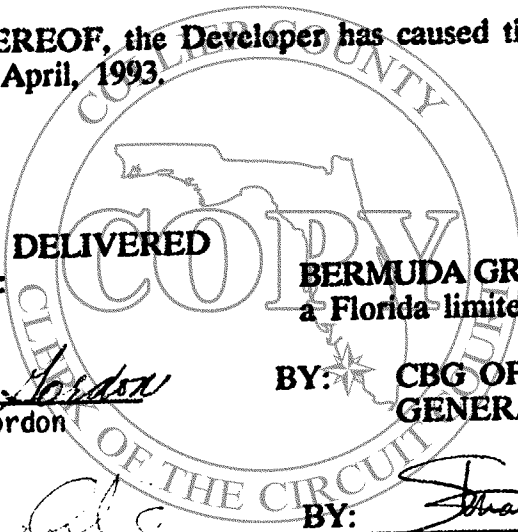

**STATE OF FLORIDA
COUNTY OF COLLIER**

The foregoing instrument was acknowledged before me this 12th day of April, 1993, by **STUART M. WALLACE**, President, of **CBG OF NAPLES, INC.**, a Florida corporation, the general partner of **BERMUDA GREENS OF NAPLES, LTD.**, a Florida limited partnership, on behalf of the partnership. He is personally known to me and did take an oath.

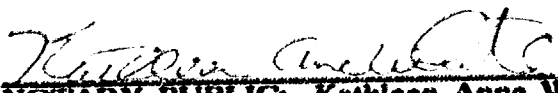
NOTARY PUBLIC: Kathleen Anne White
My commission expires:

This instrument prepared by:
John N. Brugger, Esq.
FORSYTH, BRUGGER, REINA & BOURGEOU, P.A.
600 Fifth Avenue South, Suite 210
Naples, Florida 33940
(813) 263-6000

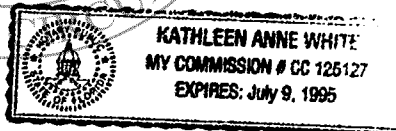
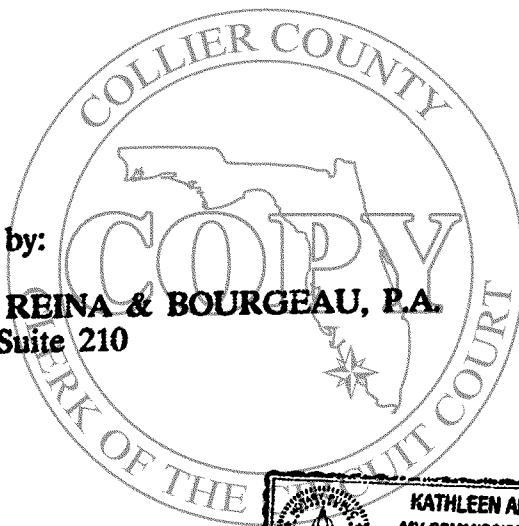

McANLY, ASHER AND ASSOCIATES, P.A.

PROFESSIONAL ENGINEERS, PLANNERS & LAND SURVEYORS
5701 TAMMING TRAIL, EAST, SUITE 202
NAPLES, FLORIDA 34102-4130
TELEPHONE 941-775-0727
TELEFAX 941-775-0236

SURVEYORS CERTIFICATE OF SUBSTANTIAL COMPLETION

CERTIFICATE OF SURVEYOR made this 12th day of April, 1993.

This certificate is made as to Building "O" of Bermuda Greens, A Condominium, Phase 2, located at Naples, Collier County, Florida, pursuant to Section 718.104 (4) (e), Florida Statutes.

I, Carol E. Nelson, a Land Surveyor authorized to practice in the State of Florida, hereby certify that the construction of the above referenced building, and all planned improvements, including but not limited to the landscaping, utility services, access to the units and common element facilities serving the buildings, have been substantially completed, so that the material attached to the Declaration of Condominium as Exhibit "B", together with the provisions of the Declaration describing the condominium property, is an accurate representation of the location and dimensions of the improvement, and that the identification, location and dimensions of the common elements and of each unit can be determined from these materials.

Prepared by:

Carol E. Nelson 4/12/93
**Carol E. Nelson, P.L.S.
Florida Registration No. 5013**

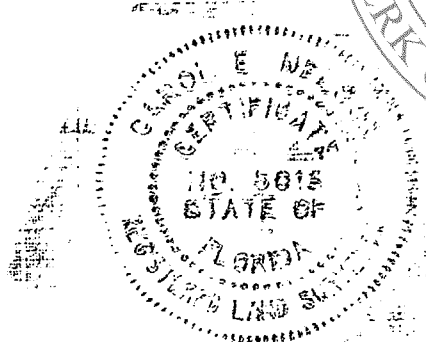
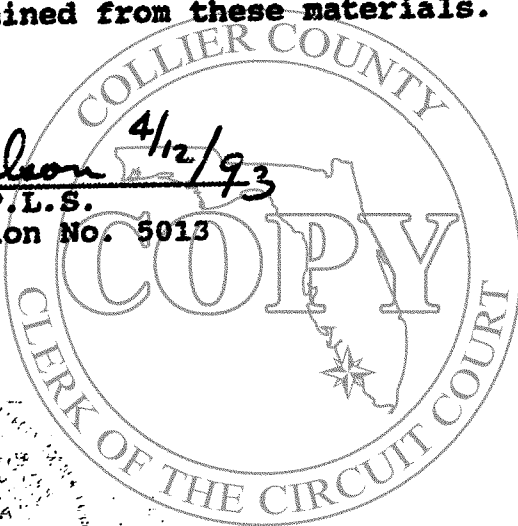

OR BOOK

1818

PAGE

001788

CONDOMINIUM PLAT BOOK PAGE
BERMUDA GREENS, A CONDOMINIUM
 PHASE II

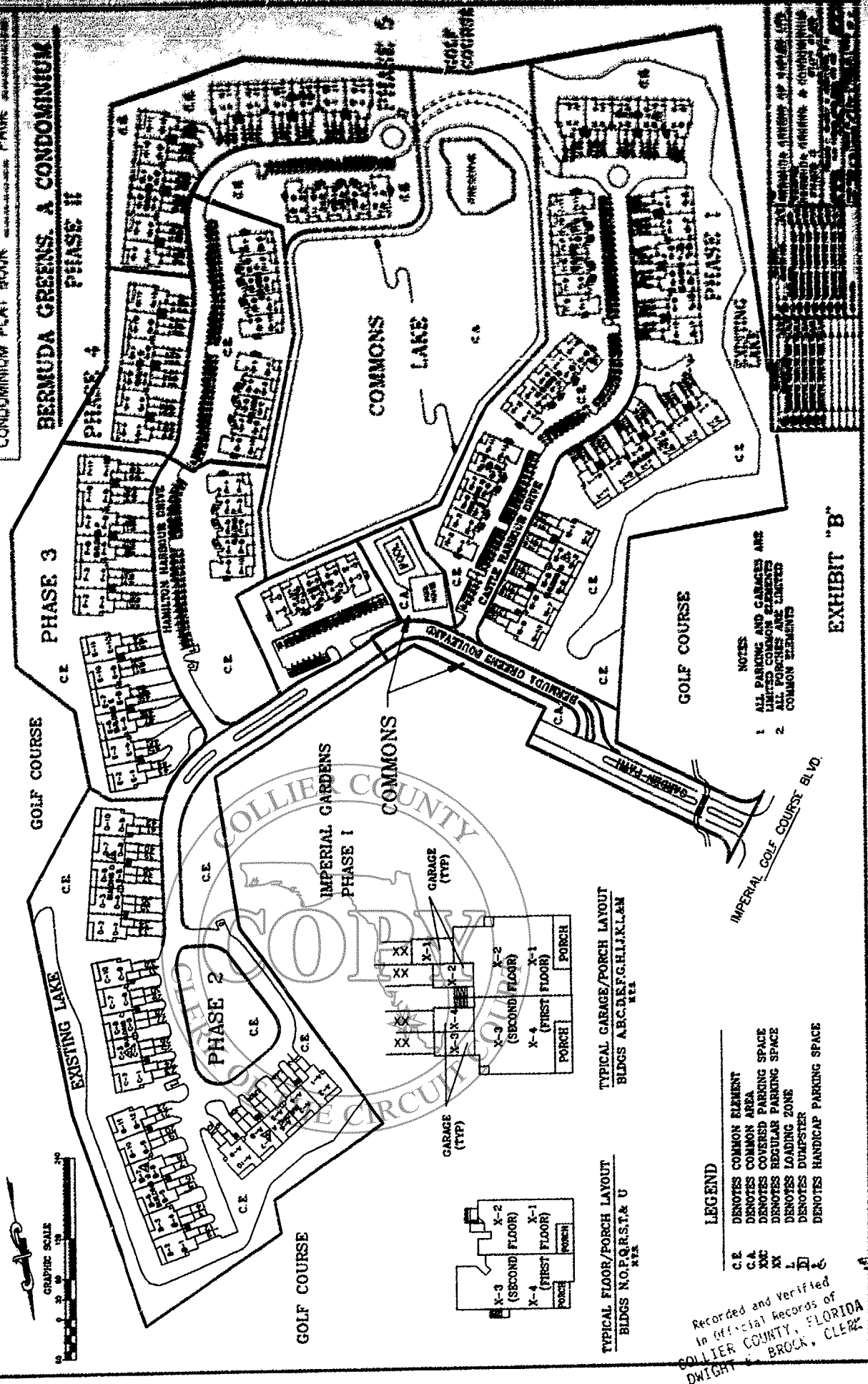

TYPICAL FLOOR/PORCH LAYOUT
 BLDGS N.O.P.Q.R.S.T. & U
 SEE

TYPICAL GARAGE/PORCH LAYOUT
 BLDGS A.B.C.D.E.F.G.H.I.J.K.L.M
 SEE

- LEGEND**
- DENOTES COMMON ELEMENT
 - C.E. DENOTES COMMON AREA
 - C.A. DENOTES COVERED PARKING SPACE
 - X.C. DENOTES REGULAR PARKING SPACE
 - XX DENOTES LOADING ZONE
 - L DENOTES DUMPSTER
 - ⊞ DENOTES HANDICAP PARKING SPACE

- NOTES**
- 1 ALL PARKING AND GARAGES ARE LIMITED COMMON ELEMENTS
 - 2 ALL PORCHES ARE LIMITED COMMON ELEMENTS

Recorded and Verified
 In Official Records of
 COLLIER COUNTY, FLORIDA
 DWIGHT BROCK, CLERK