

Update from the
BG Street Repair Committee on the
Street Repair Project
12/2/2023

Work on the project will officially start on Monday, December 4, beginning with the circle on Hamilton Harbour Dr.

Attached is the map and work schedule through December 20 affecting the buildings on Hamilton Harbour Dr, beginning with Buildings S and I.

NOTE: Once construction begins at a Zone, interruption will continue for 4 continuous workdays, (Mon - Fri).

Review the attached schedule to determine the time frame your Unit will be affected. A separate email will be sent to Buildings who may need assistance with accessing their units during this time.

A reminder to everyone to be aware of your surroundings during the project and exercise caution at all times.

Bermuda Greens - Overall Schedule for Resident Interruption

Note: once construction begins at a Zone, interruption will continue for 4 continuous workdays (M-F).

12/4/23 -----	Building I Roundabout (I12 & S1)
12/6/23-----	Building I & Building S (I10-I5 & S4-S6)
12/7/23-----	Building I & Building H (I1-I6 & H11-H12)
12/8/23-----	Building H (All Units)
12/11/23-----	Building R & Building G (R2-R4 & G4-G12)
12/12/23-----	Building G & Building F (G1-G4 & F7-F12)
12/13/23-----	Building F & Building E (F1-F6 & E9-E10)
12/14/23-----	Building E (E1-E8)
12/15/23-----	Building E (E1-E2)
12/18/23-----	Buildings R, Q, & P
12/19/23-----	Building P (P8-P12)
12/20/23-----	No Interruptions

C:\Users\ledfo\AppData\Local\Temp\AcPublish_1524\Bermuda_MST.dwg Tab: PG(6) Jul 25, 2023 - 11:36am Plotted by: ledfo

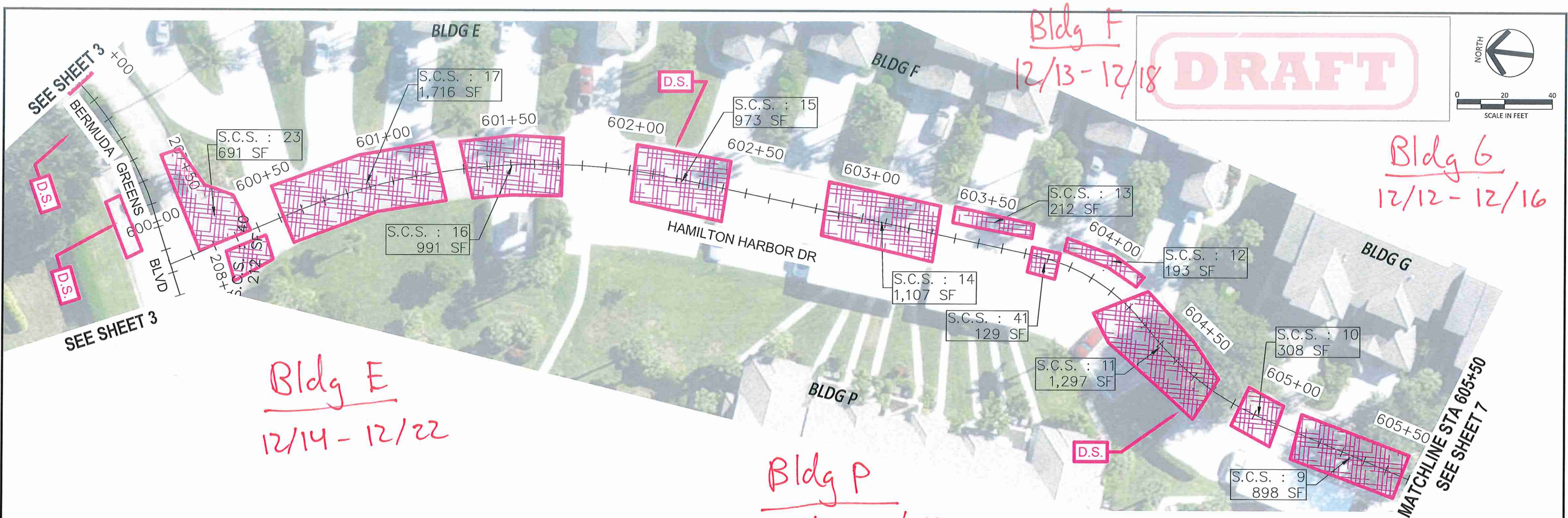

REPAIR AREA	BLDG	CRITICAL STREET REPAIR	
		AREA(SF)	DAMAGE
9	G	898	SEVERE CRACKS/SPALLING
10	G	308	SEVERE CRACKS/SPALLING
11	F	1297	SEVERE CRACKS/SPALLING
12	F	193	SEVERE CRACKS/SPALLING
13	F	212	SEVERE CRACKS/SPALLING
14	F	1,107	SEVERE CRACKS/SPALLING
15	F	973	SEVERE CRACKS/SPALLING
16	E	991	SEVERE CRACKS/SPALLING
17	E	1,716	SEVERE CRACKS/SPALLING
23	E	691	SEVERE CRACKS/SPALLING
40	E	212	SEVERE CRACKS/SPALLING
	TOTAL	8598	

HAMILTON HARBOR DR
STA. 600+00 - 605+50

REVISIONS		



BERMUDA GREENS
Condominium Association
Collier County, Florida

**BERMUDA GREENS
STREET PROJECT**

**HAGAN**
ENGINEERING
1250 TAMiami TRAIL NORTH, STE. 203B
Naples, Florida 34102
Phone (239) 851-8239

HAMILTON HARBOR DR

DATE 4/30/23	PROJECT NO. 2023-292	SCALE As Shown	SHEET 6
-----------------	-------------------------	-------------------	------------

C:\Users\ledfo\AppData\Local\Temp\AcPublish_1524\Bermuda_MST.dwg Tab: PG(7) Jul 25, 2023 - 11:36am Plotted by: ledfo

Bldg G
12/12 - 12/16

Bldg H
12/7 - 12/12

Bldg Q
12/18 - 12/22

Bldg R
12/11 - 12/14
12/18 - 12/24

Bldg G
12/4 - 12/11

Building I
Interrupted from
12/4 - 12/11

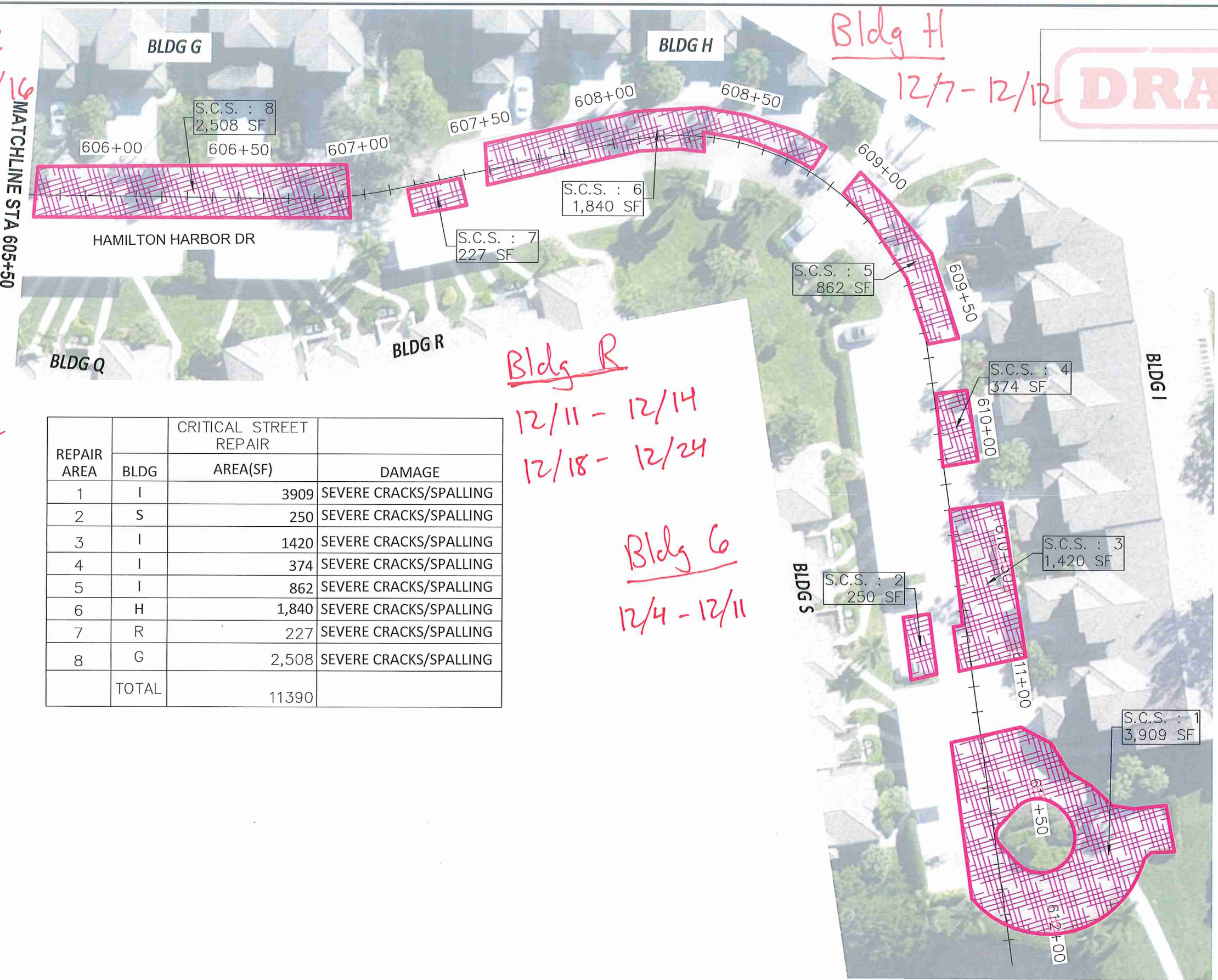

REPAIR AREA	CRITICAL STREET REPAIR		
	BLDG	AREA(SF)	DAMAGE
1	I	3909	SEVERE CRACKS/SPALLING
2	S	250	SEVERE CRACKS/SPALLING
3	I	1420	SEVERE CRACKS/SPALLING
4	I	374	SEVERE CRACKS/SPALLING
5	I	862	SEVERE CRACKS/SPALLING
6	H	1,840	SEVERE CRACKS/SPALLING
7	R	227	SEVERE CRACKS/SPALLING
8	G	2,508	SEVERE CRACKS/SPALLING
	TOTAL	11390	

HAMILTON HARBOR DR
STA. 605+60 - END

REVISIONS		



BERMUDA GREENS
Condominium Association
Collier County, Florida

BERMUDA GREENS
STREET PROJECT



HAGAN
ENGINEERING
1250 TAMiami TRAIL NORTH, STE. 203B
Naples, Florida 34102
Phone (239) 851-8239

HAMILTON HARBOR DR			
DATE 4/30/23	PROJECT NO. 2023-292	SCALE As Shown	SHEET 7